



**ACCESSIBILITY  
PROFESSIONALS**

## **Verti Lift INSTRUCTION MANUAL**



[www.AccessibilityPro.com](http://www.AccessibilityPro.com) 1-877-947-7769



Granberg Interior AB  
Box 6112  
SE-600 06 Norrköping  
SWEDEN  
Tel: +46 (0)11-19 77 50

# Content

---

Section:	Headline:	Page:
1.	Introduction.....	4
2.	Declaration of Conformity.....	4
3.	Intended use - Technical data.....	4
	<b>Installation instructions:</b>	
4.1	Mechanical construction.....	5
4.2	Delivery modules.....	5
4.3	Joist heights.....	6
4.4	Location wall socket and control devices.....	7
4.5	Preparations.....	8
4.6	Installation on wall.....	9
4.7	Installation of lighting under the safety panel (accessory).....	10
4.8	Installation of light ramp (accessory).....	10
4.9	Functional test.....	10
	<b>Operator's information:</b>	
5.1	Safe use.....	11
5.2	Safety arrangements.....	13
5.3	Load distribution and side forces.....	13
5.4	Actions after use.....	13
5.5	Alternative control devices.....	14
5.6	Cleaning.....	14
5.7	Maintenance.....	15
6.	Instructions for Recycling.....	15
7.	Decals.....	16
8.	Warranty.....	16
9.	Service & maintenance records.....	17
10.	Fault finding.....	18
11.	Spare parts list.....	18
12.	Electric circuit diagram.....	19
13.	CE-Declaration of Conformity.....	19

## 1. Introduction

We have the pleasure to deliver a Granberg Interior Verti lift unit for installation in wall cabinets. This is an electrically operated lifting and lowering system for installation in new or existing wall cabinets. It can be used separately, or together with the Granberg work top units, and it becomes then a total adaptation of the kitchen. The lift is suitable for all wall cabinets of various makes, which are made according to the standards EN 1116 and EN 1153.

### **Only authorized persons may use the Verti!**

Authorization means obligation to read and follow the instructions.

It is very important that you read and understand the instructions before you use Verti. If you have any questions - contact your supplier.

This Instruction manual shall be available for all concerned persons, be kept in a protected place and shall follow the product, if it is moved to another installation site or another house or apartment owner.

### **Correct use, operation, inspections and maintenance are decisive for efficient and safe work.**

## 2. Declaration of Conformity with EU-directive

This product is CE-marked and is granted to conform to the basic safety and operation requirements, in accordance with the actual Machinery, EMC- and Low voltage Directives. A separate "CE-Declaration of Conformity" is available in section 13.

## 3. Intended use - Technical data

The Verti Cabinet lift unit is intended to achieve a convenient location to put or pick of normal kitchen cabinet items, e.g. dry groceries and household objects, by means of manoeuvring the shelf system vertically. Verti is mounted in a kitchen cabinet of massive wood or of lacquered or laminated chipboards. The operation shall be indoors, under normal housing conditions regarding temperature, humidity and lighting.

Verti is not intended for use in moist environments.

The Verti Cabinet lift unit is delivered for installation in a new cabinet frame, comprising sides and a top board, or for installation in an existing cabinet. The shelves and the bottom board and possible backboard must be demounted before the Verti is installed.

It is assumed that the wall cabinet is made according to the standards EN 1116 and EN 1153.

### **Technical data, Verti 830 / 831**

Model	830	831
Cabinet width (inside)	460 - 960 mm	460 - 960 mm
Length of shelves	365 - 865 mm	365 - 865 mm
Cabinet height	Min. 700 mm	Min. 700 mm
Cabinet depth, min	265 mm	310 mm
Depth of shelves	242 mm	286 mm
Vertical stroke, max	470 mm	470 mm
Time for a lift or lowering stroke, approx.	10 s	10 s
Mains voltage*	120 V 1,5 A / 230 V 0,5 A	120 V 1,5 A / 230 V 0,5 A
Power consumption*	180 W / 105 W	180 W / 105 W
Max no. of full work cycles per hour	6	6
Control and lighting voltage	24 V DC	24 V DC
Weight including shelves, max. size	28 kg	28 kg
Max load in a cabinet	40 kg	40 kg
Noise pressure	Less than 70 dB(A)	Less than 70 dB(A)

\* The voltage depends on which model that is delivered.

## 4.1 Mechanical construction



The Verti Cabinet lift unit comprises a rear panel, to be mounted on a wall, a lifting mechanism and a rack with 3 shelves. The vertical lifting and lowering motions are made by an electrically powered lifting belt, which is fitted between the rear panel and the shelf rack.

## 4.2 Delivery modules

The Verti unit is delivered in a box completely assembled with shelves, lifting mechanism, control system, and upper and lower trip plate. The lift can be completed with various control units, light ramp and lighting.



Verti shelf unit

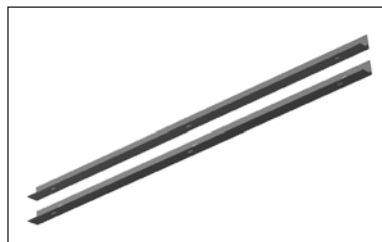

Attachment brackets

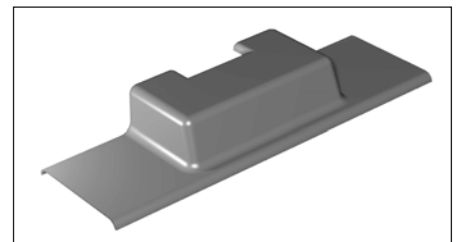

Motor cover

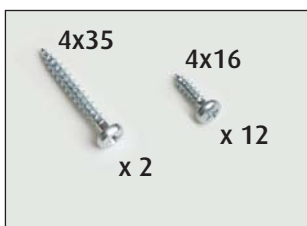

Screws



Transformer



Junction cable (accessory)



Control button box (The box on the picture is for outside installation).



Lighting (accessory)

### 4.3 Joist heights for Verti

The Verti unit is fixed to the wall through the rear panel. Laying joists shall be placed according to the dimensions below:

**A = 1440 mm from floor to centre of the joist**

**B = 2052 mm from floor to centre of the joist**

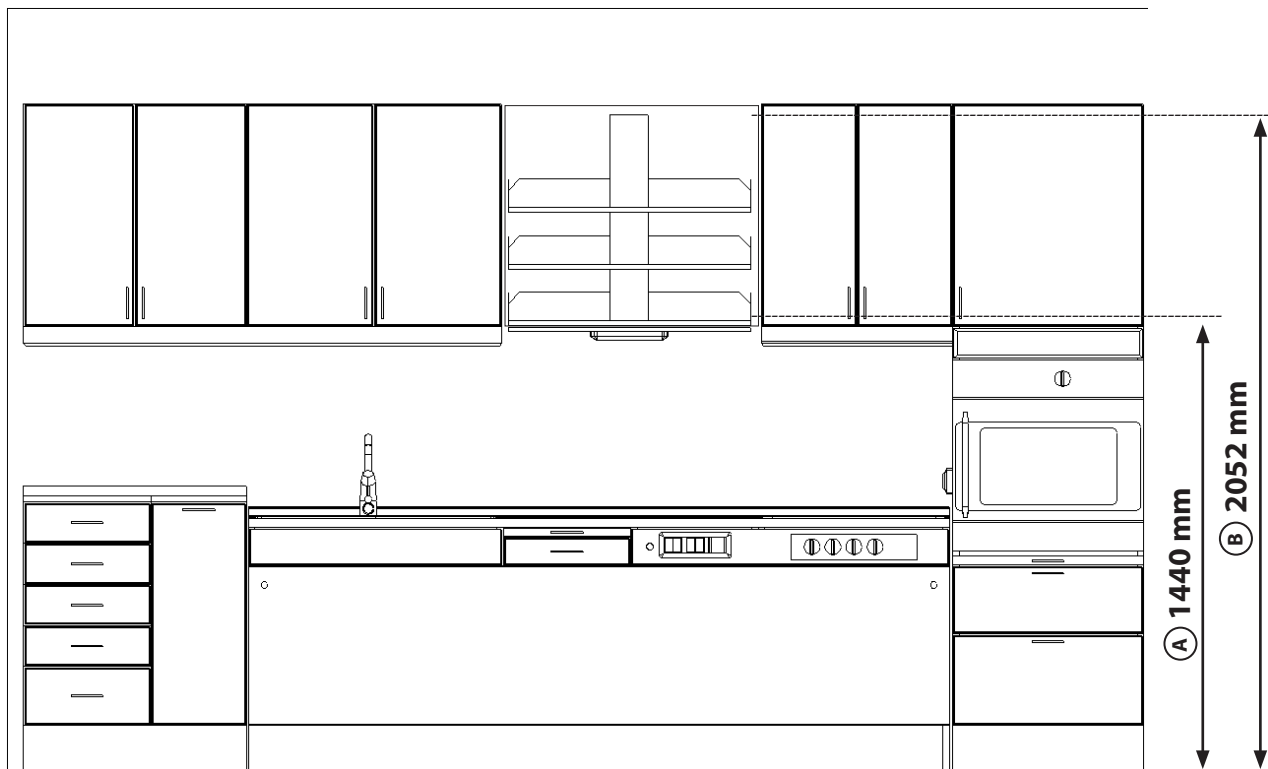

## 4.4 Location of sockets and control devices

The Verti unit shall be connected to a separate main switch, which is placed in the kitchen or its vicinity. The location of a socket for 230 V, 50 Hz / 120 V, 60 Hz (depends on model) should be coordinated with other equipment in the kitchen. The Verti wall cabinet system is often in combined with a worktop system. See pictures below for proposed locations.

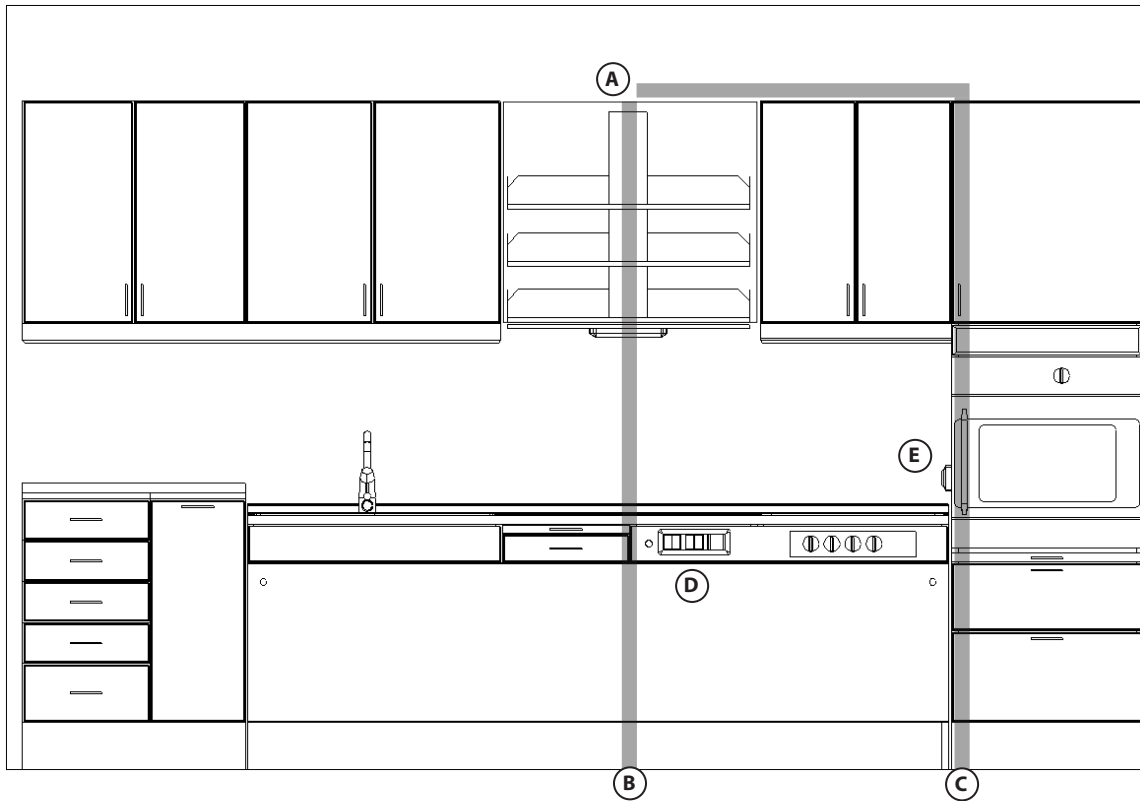

### A - Socket

The socket is placed above the cabinet.

### B - Location of VP-tube for control cable

A VP-tube is placed in the wall behind the Verti. In this the cable to the control button placed. The lower part of the tube shall exit from the wall just above the floor if the kitchen is equipped with a worktop lift. The upper part of the tube shall exit above the cabinet. The cable length is 5 meters.

### C - Alternative location of control cable

Alternative location of the control cable is through a high cabinet. The cable length is 5 meters.

### D - Proposed location of recessed buttons

Proposed location of button if the kitchen is equipped with a worktop lift. (Recessed buttons).

### E - Proposed location of outside buttons

When the kitchen is not equipped with a worktop lift the button can be placed e.g. on the side of a high cabinet (approx. 110 cm above the floor if it is placed above a worktop lift), inside a floor cabinet etc.

No socket to the lighting is required. It is connected to the circuit board of the Verti units. See section 12.

## 4.5 Preparations

The Verti unit shall be mounted inside a wall cabinet. Avoid placing Verti above the water tap, as this can prevent the Verti to be lowered to the bottom position. If necessary choose a low water tap.

### 4.5.1 Location in cabinet

At cabinet height 70 cm:

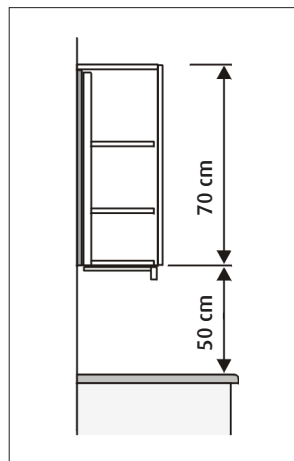
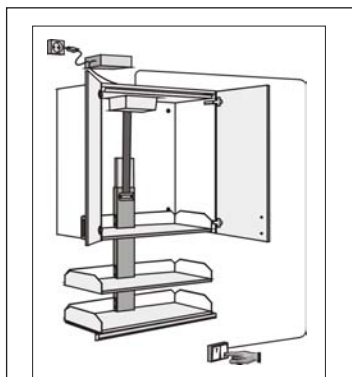

Mount the Verti unit to the cabinet top plate.

At cabinet height more than 70 cm:

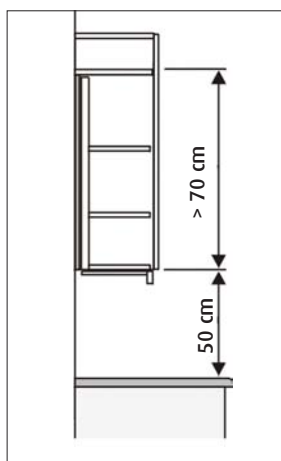
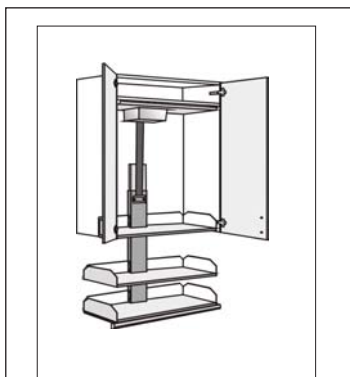

At cabinet height more than 72 cm add an additional, fixed mounted shelf in the cabinet.

Example on alternative installation:

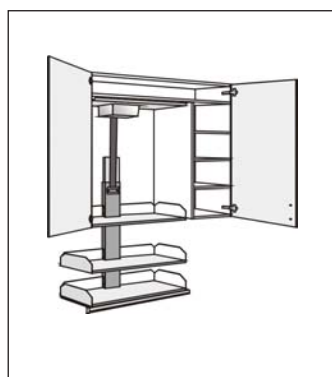

### 4.5.2 Preparations at installation of Verti in existing wall cabinet

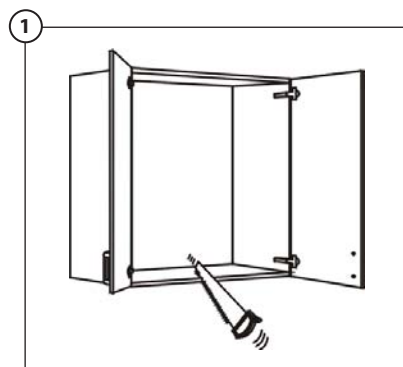

1 Remove the shelves.  
Remove the cabinet bottom.

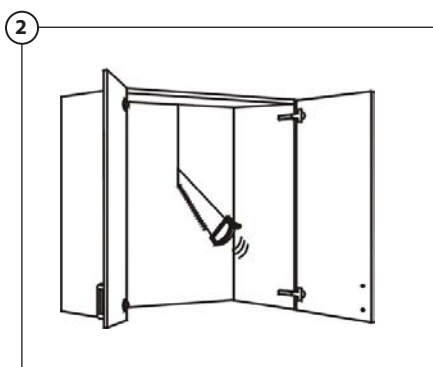

2 Remove the rear panel (backside), unless it is firmly fixed to the wall. Check that the wall has sufficient strength for the Verti unit, including the maximum load.

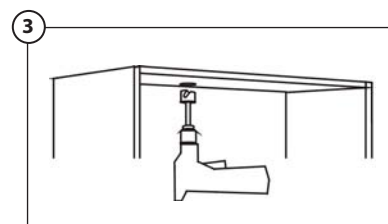

3 Make holes for cables in the cabinet top. Hole diameter min. 20 mm. To be placed approx. 150 mm to the left of the cabinet centre, and approx. 30 mm from the wall.

### 4.5.3 Preparations at installation of Verti in a Verti cabinet frame

\* The Verti cabinet frame is delivered unassembled. Assemble the sides and top.

\* Assemble the adjacent wall cabinet.

\* Install the Verti cabinet frame between the adjacent cabinets. Fix the Verti unit with screws in the adjacent cabinets. (If there are no adjacent cabinets available mount the Verti unit with consoles on the frame inside).

### 4.6 Installation on wall

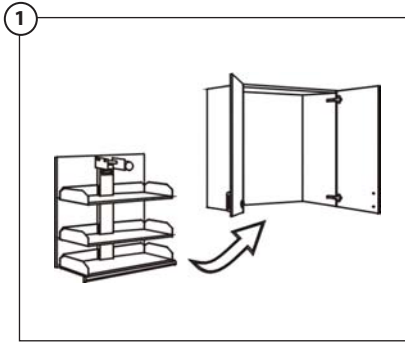

1 Place the Verti unit in the cabinet.

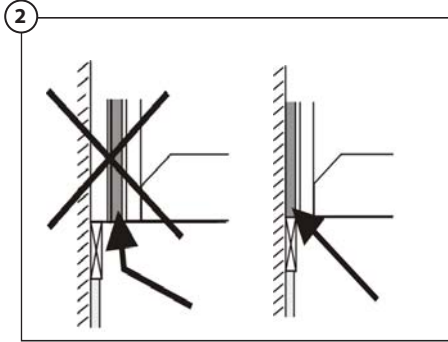

2 The Verti unit shall be mounted tightly to the wall.

**NOTE! The wall must be flat.**

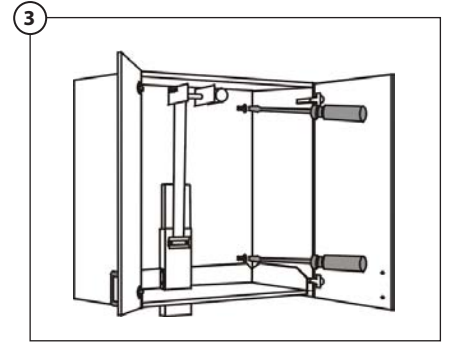

3 Fix the Verti unit rear panel fast in the wall with at least 6 screws.

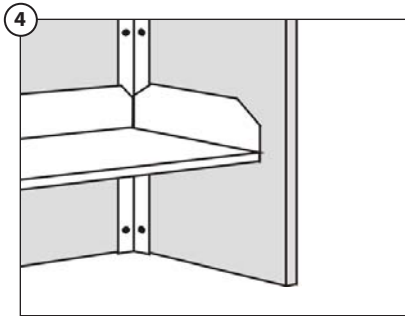

4 Fix the consoles in the corners, so that the Verti unit supports the cabinet sides.

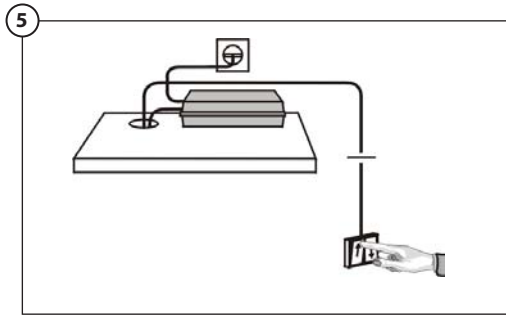

5 Install the transformer on the cabinet top plate alternatively on a fixed shelf in an adjacent cabinet. The socket shall be possible to reach after the installation is finished.

\* Connect the cable to the UP/DOWN control unit acc. picture. Make sure that the cable cannot be jammed.

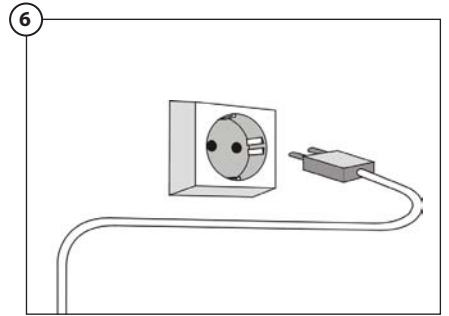

6 The connection to the socket shall be easily accessible, so that it can be disconnected when needed.

The cable shall be placed so that it is not exposed to heat.

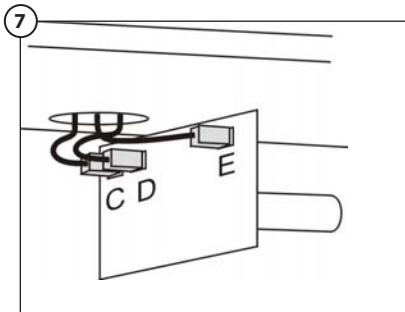

7 Connection on the printed circuit board  
 C = Current in 18 V from transformer  
 D = Possible mains feed to the next Verti unit  
 E = Control devices UP/DOWN

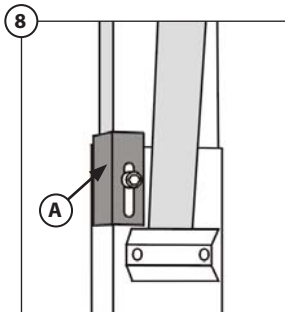

8 Adjust the top position by means of moving the consoles (A) up or down.

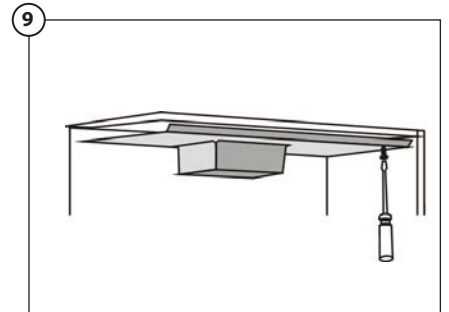

9 Fix the motor cover with the screws. The rear part shall hang in consoles on the rear panel. The front part shall be screwed into the cabinet top. Remove the protection film from the cover.



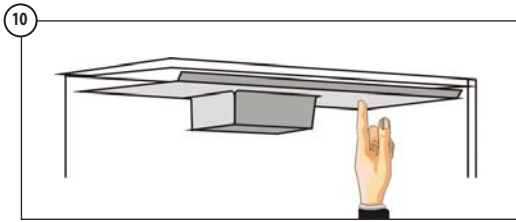

Check the break function of the upper trip plate. The shelves shall reverse downwards when the trip plate is pressed.

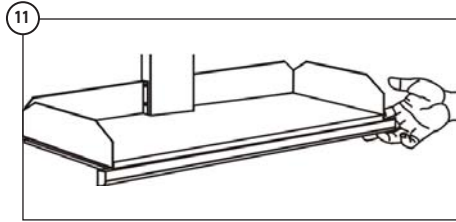

Check the break function of the lower trip plate. The shelves shall reverse upwards when the trip plate is pressed.

## 4.7 Installation of lighting under the trip plate (Accessory)

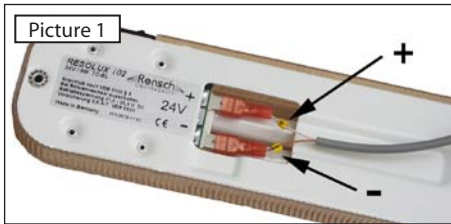

**4.7.1** Connect the electric cable to the lighting acc. picture 1. Plus and minus to be connected according the cable marking.

**4.7.2** Demount the lighting plastic cover and install the lighting under the trip plate. Use the included screw. See picture 2.

**4.7.3** Fix the cable with the included tension reliever. See pos. (C), picture 2.

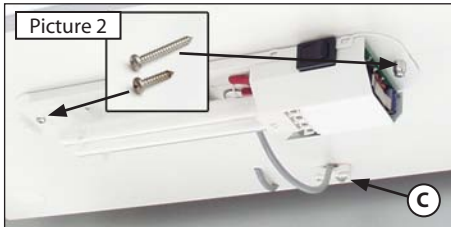

**4.7.4** Connection can be made to the printed circuit board (see section 12 or to a separate transformer).

### NOTE!

Only the Granberg original lighting grants full safety.

## 4.8 Installation of light ramp (Accessory)

Install the light ramp with angles on the trip plate. (Angles and screws are not included).

### NOTE!

The light ramp must not be mounted under the cabinet, only under the trip plate, as the trip plate function otherwise is lost.

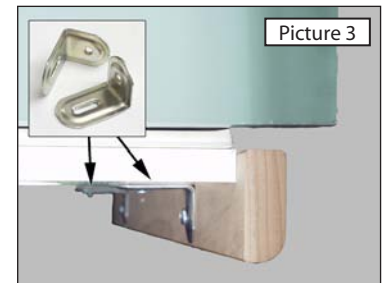

## 4.9 Functional test

**After installation a complete functional test with full load shall be made:**

- \* Run the Verti down and up all the way to respectively end position. Check that it moves freely, without hindrance and jarring sounds. Check that no cables are jammed.
- \* Lower the shelves shortly. Press the trip plate under the shelves and check that the shelves are moving upwards until the plate is not pressed any longer. If there is a malfunction, contact the installer.
- \* Check that the upper trip plate (plastic cover) works. Press it with your fingers. The lift unit shall then move downwards.

## 5.1 Safe use

In order to utilise the properties of Verti lift and to prevent and avoid damages it is important that you carefully read the instructions and operates it in the right way.

- Only use the Verti for its intended purpose.
- The operation and use must be made in such way that there is no risk for damages on persons and property.
- Be aware of that you as an operator are responsible for that nobody is damaged.
  
- The lift and the work area must be in proper condition. The Verti must not be used if any fault has appeared which influences the functions or the operation safety. It shall also not be used if it has been repaired, altered or adjusted without permission of a responsible person.
- The Control devices shall be placed so that the operator has got full view over Verti and its work area when operations are made.

### Placement of household items.

Place the goods in good order with de most frequently used at the lower part of the cabinet. Make sure that the objects do not extend outside the shelves. Mind that the objects may roll, slide or fall out of the cabinet. Spread out light and heavy items so that the weight is uniformly distributed and balanced on the shelves. See the acceptable load distribution in section 5.3.

### Suitable items to be placed in Verti

In the cabinet you can keep e.g.: crockery, drinking glasses, bowls, cups, and mugs, groceries in hard packages.

### Unsuitable items

Saucepans, fry pans and other items with projecting long handles. Cutlery and other small loose items, unless they are placed in stable holders. Fluids, e.g. drinks in soft packages. Items packed in soft plastic or papers bags. Carving knives.

Acceptable height for objects placed in the mid section of the upper shelf

The max. height of objects on the upper shelf in the mid section is 10 cm (up to the belt attachment screws) **(A)**. At the sides max. 23 cm.

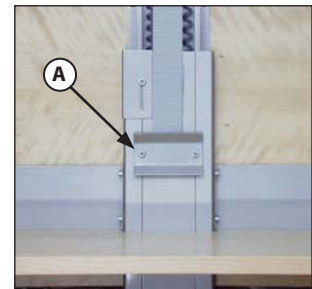

### Running up or down

The Verti unit lowers or raises the shelves in a vertical movement to or from a work area under it. Operation is made with the buttons UP respectively DOWN (marked with arrows for the resp. directions). The movement continues as long as the button is kept pressed, or to until the end position is reached. Only press the button for the desired direction. Do not touch any part of the lift, cabinet or the shelves during operation.

### Only operate one lift unit at a time

If the kitchen contains more than one lifting unit you may only operate one lift at a time, to make sure of that you have full control over the movements.

### Operation with open or closed cabinet doors

The cabinet doors may be open or closed. Observe the following:

- \* Open doors: Increased risk that instable items will fall out from shelf.
- \* Closed doors: Make sure that no items are projecting outside the shelves as these can be tripped by the bottom edges of the cabinet doors.

### If any fault occurs

If tripping or any other fault appears during operation the control button shall be released immediately, so that the movement is stopped. If driving in opposite direction will rectify the fault, such action is acceptable.

If the fault is of any other kind, such as that the cabinet lift unit moves without a control device is pressed, the electric feed shall be broken immediately, by means of removing the electric plug from the wall socket, or to switch off the main switch. Then call the installer for repair.



Be aware of the trapping risk between the shelves and the cabinet sides and between light ramp and adjacent cabinets or devices.



At lifting with closed cabinet doors there is a risk to be trapped between a shelf and a door or if an object is placed too far out on the shelf it may come in contact with the cabinet door.



Do not put hands, arms, or any other part of the body or any object into the Verti unit when the shelves are in motion.



Do not lower the Verti the space below it is free from persons or obstacles. In particular if the Verti unit is installed above a workbench with adjustable height there is an imminent risk that you do not notice objects or equipment that might be trapped.



Observe the risk for collision between the Verti unit and the Workbench. Turn the water tap and its lever towards the wall before operating the Verti, otherwise there is a risk that the cabinet will jam the spout of the water tap and the control lever.



Notice the jamming risk between obstacles on the top shelf and the cabinet top. At the drive arrangement in the middle of the top plate the height space is further limited.

Do not overload the Verti and do not put objects, which protrude outside the shelf dimensions

- Never let the Verti come in contact with adjacent objects.
- Safety devices must not be taken out of service or removed.
- Alterations of the Verti that influence the operational safety or the functions are not allowed.
- Decals and markings must not be removed or made illegible.
- Use safe and sufficient lifting methods, when handling load to and from Verti. In particular beware when handling heavy items, and goods with hazardous content or with sharp corners and edges.
- The Verti unit shall regularly, once a year, be inspected in order to prevent accidents.
- Applicable Building and Safe use Regulations must be complied with.
- It is forbidden to stay in wall the cabinet, to hang in the cabinet shelves or to use the lift for lifting of persons.
- Do not use the Verti as a lifting jack, e.g. for lifting from the floor.
- The machine must not come in direct contact with food
- Do not use the Verti in a potentially explosive environment.
- When the operation is in a public location, particularly when children can enter the work area, the operator shall make satisfactory arrangements to prevent persons from entering the hazardous area when the lift is being operated, or it has been lowered from the parking position, e.g. by means of blocking the work area or by means of adding protection devices.
- During inspections, service and repair work there shall be no load in the cabinet. It can be necessary to demount the shelves from the lift to carry out service or repair.
- Competent persons only must carry out • Installation, service and repair works.
- Only Granberg original spare parts shall be used when replacing any parts. Our warranty commitment can otherwise be invalidated.

## 5.2 Safety arrangements

Below the bottom shelf there is a fully covering safety trip plate with reversal operation. If the trip plate is pressed the Verti will lift until the obstacle that activated the movement does not actuate the trip plate any longer.

At the lift top there is also a safety trip plate, which stops the lifting motion if any object on the upper shelf is too high. Be aware of that the trip plate requires a certain force to become activated, so too brittle objects may break before the safety plate has been pressed in. The trip plate function shall be checked often. (See section 4.9)

## 5.3 Load distribution and side forces



Incorrect load distribution!  
All heavy items placed to the right.



Correct load distribution!  
The load is uniformly distributed in the cabinet.

### Basic loading requirements:

- \* **100 % of the rated load distributed over the entire cabinet volume.**
- \* **The Centre of Gravity of the load is assumed to be in or under the cabinet centre.**
- \* **Horizontal forces are not allowed.**

Horizontal forces can appear, for example, when pressing onto the shelves or the load. It is difficult to estimate the size of the actual horizontal force, so utmost care must always be taken.

Further to the incorporated safety arrangements additional safety actions may be required on or at the Verti lift. Discuss suitable actions with your Granberg representative or with the health and safety inspection.

We recommend that a Risk assessment in accordance with the Machinery Directive shall be made for the actual working conditions.

If the owner fits accessories, contact Granberg to get approval of the loading conditions.

## 5.4 Actions after use

The Verti unit shall after use be left fully raised to the top level, the parking position.

Switch off the main switch and lock it in closed position, if unauthorized use can occur. To prevent unauthorized use it is also possible to furnish the control panel with a key switch, by means of which the control circuit is disconnected. It can also be placed inside a lockable cabinet.

## 5.5 Alternative control devices

The operator shall have a clear view of the hazardous parts of the Verti and its motions, but not directly within the work area, as there is a risk that objects may fall out of the cabinet. (Due to limited space it can be necessary to place the control devices is placed within the work area).



### Control buttons UP / DOWN of plastic, fitted on the front.

The button unit is mounted on the outside of a panel, e.g. on front of the bottom cabinet, on a wall or on a cabinet side.



### Control buttons UP / DOWN of plastic, recessed.

The button unit is mounted recessed in workbench front, cabinet side etc. A control position frame for several control devices can be ordered, to be able to control more lifting devices and the lighting from one position.



### Handheld control unit mounted on a spiral cable.

The control unit is provided with a hook on the backside, as suspension device. Self-adhesive Velcro pads are included, to enable suspension position according to your own choice.

A cable shall be fixed mounted between the junction box in the Diagonal lift and the connection for the spiral cable. The connection plug is included.



### Frame for several control devices

If the control devices have been brought together to a common control station it is important to clearly mark which buttons control resp. lifting device. This will decrease the risk for operating another lifting device than the desired.

In order to prevent unauthorized use the control position can be provided with a key switch.



### Remote control with handheld control unit

The IR-receiver is placed above the cabinet and is connected to lifts' control device socket

Before the receiver is permanently fixed, check that it is placed so that the signals from the hand unit reach the receiver when the operator is on a convenient and safe control position.

See also section 5.1, "Safe use", regarding safe conditions and risks at handling the machine and the load!

## 5.6 Cleaning

In its use in a kitchen environment the mechanism can be exposed to dirt. As the Verti unit contains electrical components it is very important that cleaning is made according this instruction.

### WARNING!

\* **The Verti unit must absolutely not be connected to the electric supply when cleaning is carried out.**

\* **The Verti unit must absolutely not be rinsed with water!**

### Care instructions:

The Verti unit is cleaned with lukewarm water and a non-scratching detergent containing soap or similar. Use a Wettex swab or similar. After cleaning the surfaces shall be dried to avoid lime deposits.

**Scratching detergents or tools e.g. steel wool may not be used.**

The kitchen cabinets shall be cleaned and maintained in accordance with the manufacturers' instructions.

## 5.7 Maintenance

The Verti is maintenance-free. Greasing and other actions are made during the manufacturing for the lifetime of the Verti. From safety point of view however some components shall be inspected each year.

- \* Inspections, service and repair work shall be made by competent persons.
  - \* Remove the objects from the cabinet before maintenance and repair works are made.
1. Run the lift down and up all the way to resp. end position. Check that it runs freely without trapping risks and jarring sounds. Check that it stops and stays in the lower resp. upper positions.
  2. Lower the shelves a bit. Press the trip plate under the shelves and check that the lift moves upwards until the actuation of the trip plate ceases. If there is any fault, contact the installation company.
  3. Check that the upper trip plate (plastic cover) works. Press onto it with your fingers. The lift unit shall then move downwards. If there is any fault, contact the installation company.
  4. Check the points below. If you suspect any fault, contact the installation company!



Check that the drive belt is undamaged.

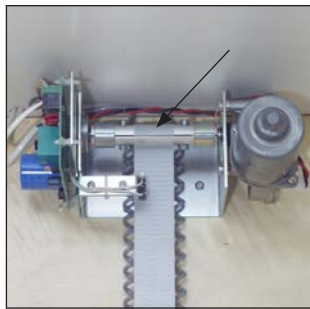

Check the attachment of the drive belt onto the belt axle (remove the cover).



Check the drive belt attachment in the aluminum the profile.

5. Check that the cables are not chafed, squeezed or breaking.
6. The cabinet lift unit can be loaded with max. 40 kg. Check that the total weight of the content on the shelves does not exceed the allowed value.
7. Check that the wall, cabinet and shelf attachment are in proper order.
8. If lighting is included in the delivery:  
Check that the lamp glass and the fluorescent tube are undamaged. If there is any fault, contact the installation company.

**ACCOMPLISHED INSPECTIONS AND REPAIR WORKS SHALL BE SPECIFIED IN THE SERVICE RECORDS IN SECTION 9.**

## 6. Instructions for recycling

When the Verti unit shall be re-used shall it must be cleaned, inspected and go through a full operation test before it is installed on the new site.

We recommend the machine to be sent to Granberg or to the Granberg distributor to get this done.

The machine is manufactured from re-usable materials or from materials that can be recycled.

## 7. Decals



The Max. load decal shall be placed in the cabinet.



The decal that explains that the kitchen is specially equipped shall be placed close to the control button. (The decal is included in the instruction manual).

## 8. Warranty

In accordance with the warranty conditions Orgalime S 2000 the manufacturer will replace or repair all faults which depend on manufacturing or material faults and which appear within twenty-four (24) months from the delivery. For further details about the conditions, see Orgalime S 2000.

Note! Alternative warranty conditions may apply. See the Order Acknowledgement for actual conditions.

The warranty is only valid if inspections and maintenance is carried out in accordance with the instructions. This warranty does not cover the cost of normal maintenance, settings or scheduled adjustments as specified in the instructions. Also the labour costs for such actions are not covered by the warranty.

Damages caused by misuse or incorrect operation of the equipment means that the warranty would expire.

Before any warranty work is commenced by a customer Granberg must be contacted for analysis and approval. We do not accept to carry any warranty costs if the repair work has started without an agreement by us.

Do not return any parts that have been worn out during normal operation or accidentally damaged. Only return worn or damaged parts if it is considered that the fault is covered by our warranty conditions. In such cases, return the parts without delay, otherwise the right to replacement may be lost.

When returning parts always quote the details shown on the manufacturer's plate, i.e. Type, manufacturing number, year and describe the operating conditions for the machine.

**Remember to quote name, address and telephone number for the appropriate contact person.**

## 9. Service and Maintenance Records

Type and model: \_\_\_\_\_ Manufacturing No.: \_\_\_\_\_

Delivery date: \_\_\_\_\_

Service & maintenance Date: _____ Sign. _____ Remarks: _____ _____ _____	Service & maintenance Date: _____ Sign. _____ Remarks: _____ _____ _____	Service & maintenance Date: _____ Sign. _____ Remarks: _____ _____ _____
Service & maintenance Date: _____ Sign. _____ Remarks: _____ _____ _____	Service & maintenance Date: _____ Sign. _____ Remarks: _____ _____ _____	Service & maintenance Date: _____ Sign. _____ Remarks: _____ _____ _____
Service & maintenance Date: _____ Sign. _____ Remarks: _____ _____ _____	Service & maintenance Date: _____ Sign. _____ Remarks: _____ _____ _____	Service & maintenance Date: _____ Sign. _____ Remarks: _____ _____ _____



## 10. Fault finding

The Verti wall cabinet lift unit is designed and tested to achieve optimum operation reliability and long life, provided that the operation, maintenance and inspections are carried out in accordance with the prescribed instructions. If in spite of this a fault appears you can get guidance about what to do according to the faultfinding list below.

Remove the load from the cabinet before fault finding and repair work is carried out.  
Fault finding, service and repair work shall be made by competent persons only.

If any problem remains after you have taken actions in accordance with the list below you must contact a competent technician or your supplier.

Symptom	Action
The shelves do not move when a control signal is given	Check that the fuse for the mains feed is not damaged.
	Check that the mains plug is connected.
	Check that the safety trip plate is not actuated.
	If the shelves still do not move contact an authorized technician and/or your supplier.
	This shall as first action, after above check points, check that all cables are connected and undamaged.



A

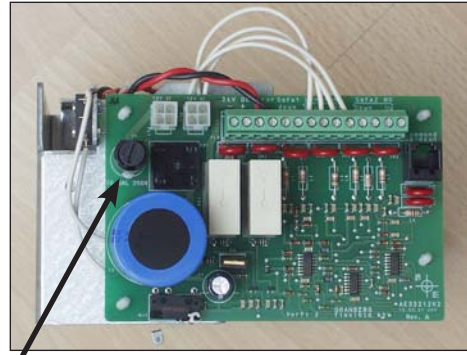

B

**WHEN REPAIR WORK HAS BEEN CARRIED OUT ON THE VERTI UNIT A COMPLETE FUNCTIONAL TEST WITH FULL LOAD SHALL BE MADE, BEFORE IT IS TAKEN INTO USE. (SEE SECTION 4.9)**

## 11. Spare parts list

If any component does not work or has broken, contact your supplier. Only Granberg original spare parts must be used when replacing any parts. Our warranty commitment may otherwise be invalidated.

### Return of spare parts:

Contact Granberg prior to any return of parts.

Do not return any parts that have been worn out during normal operation or accidentally damaged. Only return worn or damaged parts if it is considered that the fault is covered by our warranty conditions. In such cases, return the parts without delay, otherwise the right to replacement may be lost.

When ordering spare parts always quote the manufacturing number and type.

Pos: Description:

- |   |   |
|---|---|
| 1 | Transformer                             |
| 2 | Recessed control device, aluminium      |
| 3 | Handheld control unit with spiral cable |



2



3



## 12. Electric circuit diagram

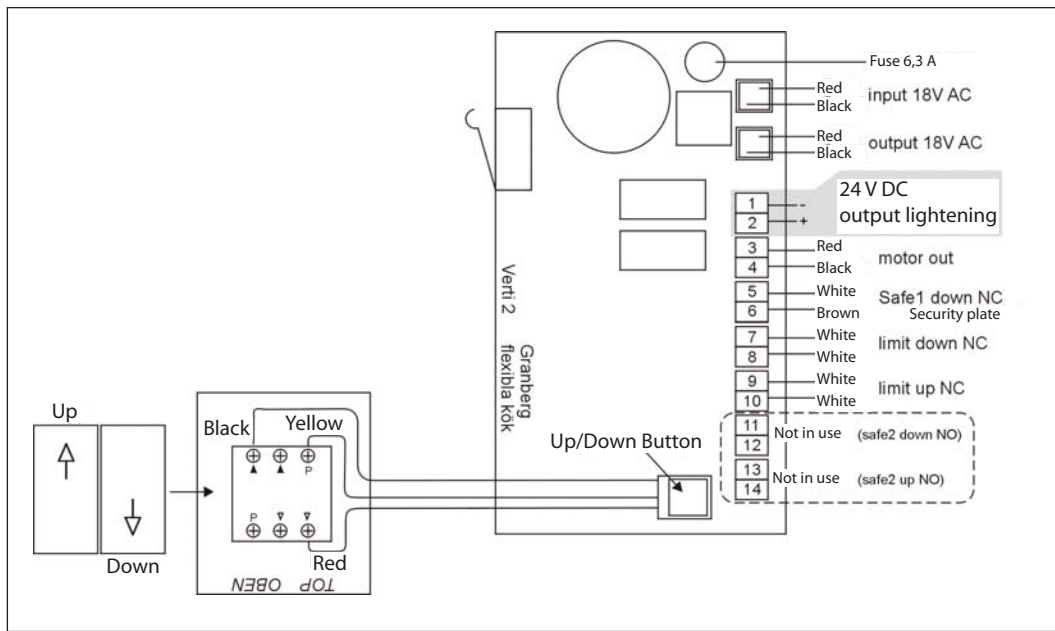

## 13. CE-Declaration of conformity

(According Machinery Directive 98/37/EC, Annexe 2A)

Manufacturer: Granberg Interior AB  
 Box 6112,  
 SE-600 06 NORRKÖPING, Sweden

Tel. +46-11-19 77 50  
 Fax +46-11-12 76 76

declares under sole responsibility that the product:

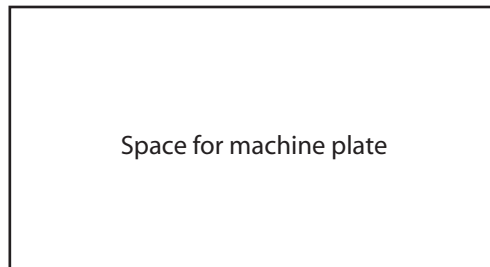

to which this declaration relates, is in manufactured in conformity with the following harmonised documents, following the provisions of Machinery Directive 98/37/EC, the Low Voltage Directive 73/23/and the EMC Directive 89/336/EEC It also conforms to the following harmonised standards:

EN 60204-1 Safety of Machinery - Electrical Equipment of Machines -General Requirements

Norrköping, 2006-04-20  
 Granberg Interior AB

*Tobias Granberg*

Tobias Granberg  
 Managing Director